

# Surgical Trailer

## 12' x 55'

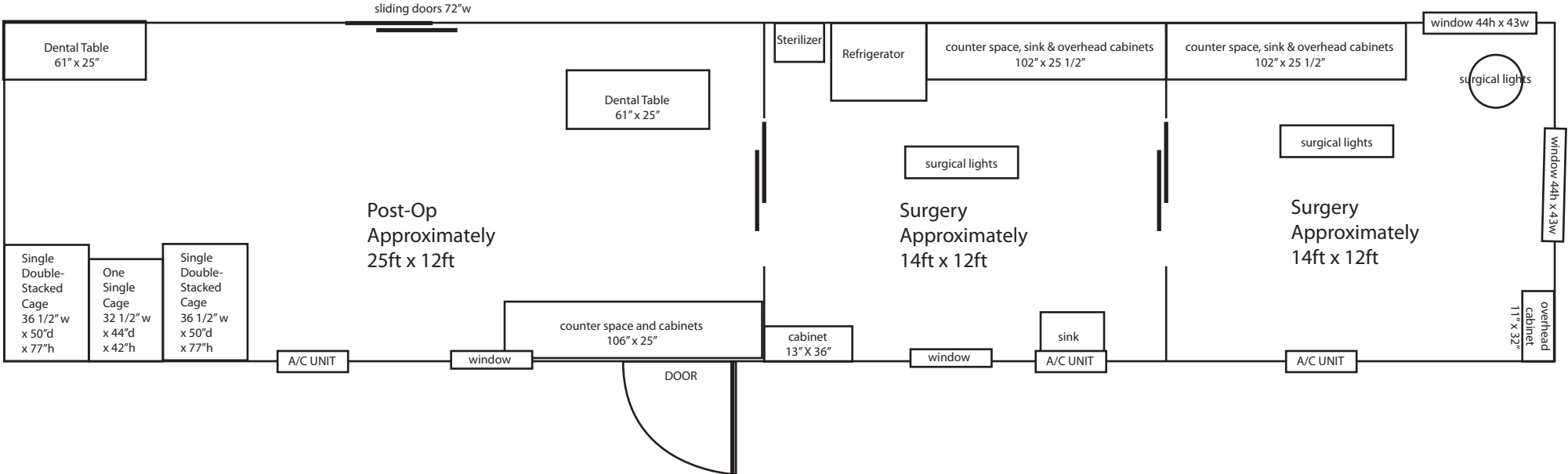

Dental Table  
61" x 25"

sliding doors 72"w

Dental Table  
61" x 25"

Sterilizer

Refrigerator

counter space, sink & overhead cabinets  
102" x 25 1/2"

counter space, sink & overhead cabinets  
102" x 25 1/2"

window 44h x 43w

surgical lights

surgical lights

surgical lights

vertical window 44h x 43w

Post-Op  
Approximately  
25ft x 12ft

Surgery  
Approximately  
14ft x 12ft

Surgery  
Approximately  
14ft x 12ft

Single  
Double-  
Stacked  
Cage  
36 1/2"w  
x 50"d  
x 77"h

One  
Single  
Cage  
32 1/2"w  
x 44"d  
x 42"h

Single  
Double-  
Stacked  
Cage  
36 1/2"w  
x 50"d  
x 77"h

A/C UNIT

window

counter space and cabinets  
106" x 25"

DOOR

cabinet  
13" X 36"

window

sink

A/C UNIT

A/C UNIT

overhead  
cabinet  
11" x 32"